



**ELECTRO ADAPTER, INC.**  
 CHATSWORTH, CALIFORNIA, USA 91311  
 PHONE: (818) 998-1198  
 FAX: (818) 709-5773  
 www.electro-adapter.com

# CFS EMI/RFI ADAPTER

SPECIFICATION CONTROL DRAWING

308

PAGE 1 OF 2  
 △ ADAPTER STYLE INFO SHEET

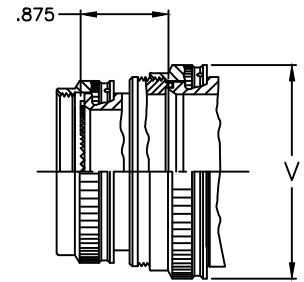
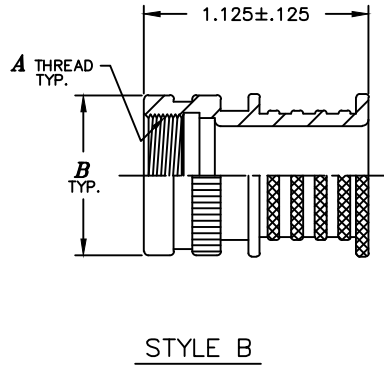
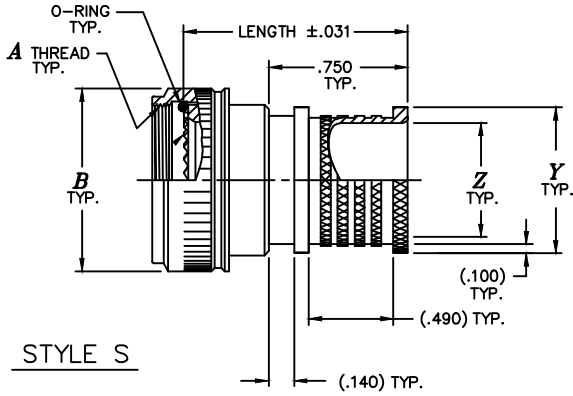

**TWO PIECE**  
 SUPPLIED WHEN CABLE DIA.  
 EXCEEDS CONNECTOR INSERT DIA.

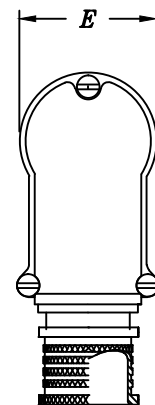
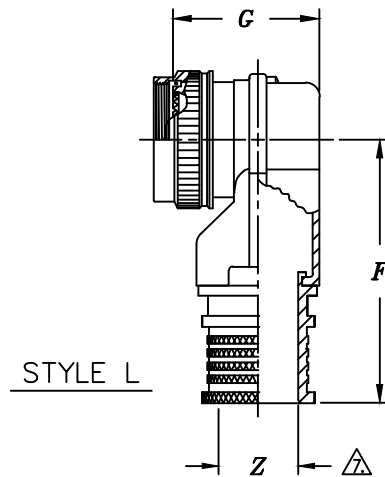
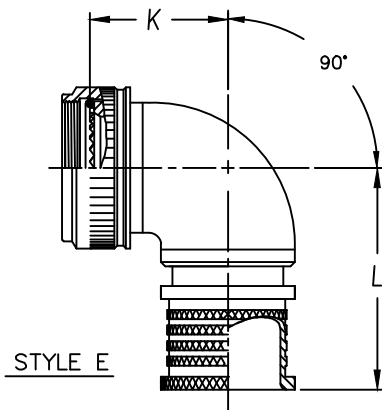
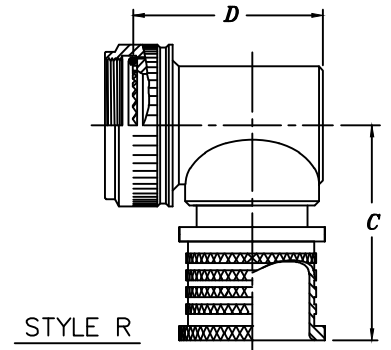
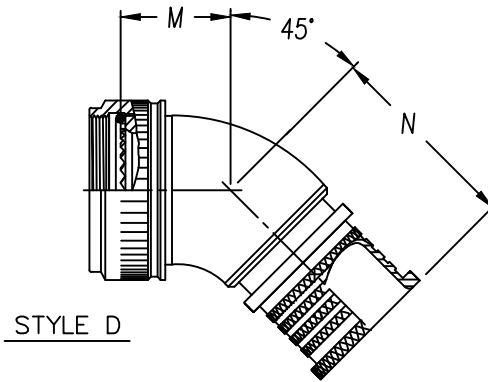
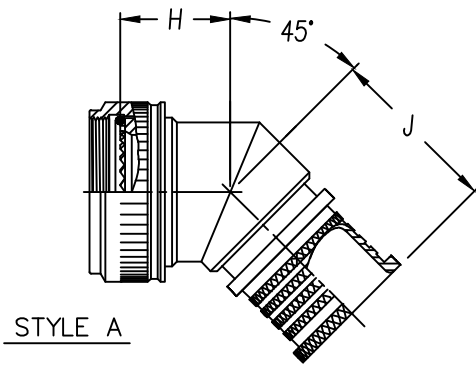

UNLESS OTHERWISE SPECIFIED DIMENSIONS ARE IN INCHES	MATERIAL AND FINISH PER NOTES DO NOT SCALE DRAWING	TOLERANCES:	.XX = ± .06	CAGE CODE 31461	FILE NO. 0\SALES\30800	DR ATP 5/3/04	CHK G.F.	APP 02/26/09	REV. D
			.XXX = ± .03						



*Example Part Number*

30840S10040556 <sup>△</sup>

BASIC ADAPTER NUMBER

ORDER NO.  
PER TABLE II

PLATING CODE NUMBER

14 = ZINC COBALT PER ASTM B840-99 BLACK

55 = CADMIUM, OLIVE DRAB, PER SAE AMS-QQ-P-416, CLASS 3, OVER ELECTROLESS NICKEL PER AMS-C-26074, GRADE B

56 = ALUMINUM, ELECTROLESS NICKEL PER AMS-C-26074, CLASS 3 OR 4, GRADE A.

FOR ADDITIONAL FINISH OPTION, SEE CATALOG TABLE 4

LENGTH CODE

LENGTHS ARE CHOSEN IN 1/4" INCREMENTS (ie 08=2.00") 05=1.25 MIN. ORDER LENGTH INSERT "00" WHEN ORDERING AN ADAPTER STYLE A, B, D, E, L, OR STYLE R.

CONNECTOR CODE		
MILITARY SPECIFICATION	SERIES	CODE NO.
MIL-C-5015	3100	18
MIL-C-26482	1	21
MIL-C-38999	III & IV	40
MIL-C-38999	I & II	41
MIL-C-26482	2	54
MIL-C-5015G	3400	54
MIL-C-81703	3	54
MIL-C-83723	I	54
MIL-C-83723	III	54
NAS1599	-	54
LITTON VEAM CIR	-	64
AB 05	DEF.STD.59-35 PART 1, SEC.3	76
PATT 121	DEF.STD.59-35 PART 1, SEC.8	78

ADAPTER STYLE  
 STYLE S = STRAIGHT ADAPTER  
 STYLE R = 90° ADAPTER  
 STYLE A = 45° ADAPTER  
 STYLE L = 90° LOW PRO SPLIT  
 STYLE D = 45° TUBE  
 STYLE E = 90° TUBE

TABLE I - ENTRY DATA				
ORDER NUMBER	ØZ ±.020	ØY REF.	ØV MAX	SPRING NO. 901-436--
02	.125	.450	N/A	-1
03	.188	.512	N/A	-1
04	.250	.575	N/A	-1
05	.312	.638	.734	-1
06	.375	.700	.734	-1
07	.438	.762	.858	-1
08	.500	.825	.858	-2
09	.562	.888	1.112	-2
10	.625	.950	1.112	-2
11	.688	1.012	1.345	-2
12	.750	1.075	1.345	-2
13	.812	1.138	1.345	-2
14	.875	1.200	1.345	-3
15	.938	1.262	1.594	-3
16	1.000	1.325	1.594	-3
17	1.062	1.388	1.594	-3
18	1.125	1.450	1.594	-3
20	1.250	1.578	1.969	-3
22	1.375	1.700	2.209	-4
24	1.500	1.825	2.459	-4

NOTES: UNLESS OTHERWISE SPECIFIED

- ASSEMBLY IDENT. PER MIL-STD-1285.
- MATERIAL: COMPONENTS - ALUMINUM ALLOY OR O'RING - SILICONE HARDWARE - SST
- ADAPTERS SUPPLIED WITH SPRING. SEE 901-436 300 SERIES STAINLESS STEEL
- CONSULT FACTORY FOR ADDITIONAL SIZES, CONNECTOR CODES, AND/OR INFORMATION.

REFER TO STYLE INFORMATION SHEET FOR ADDITIONAL CONFIGURATIONS.

THIS DOCUMENT IS INCOMPLETE WITHOUT INTERFACE SPECIFICATION SHEET

MAX ENTRY FOR STYLE L IS .875" (14). CONSULT FACTORY FOR AVAILABE CONNECTOR CODES.

ADD "S" FOR SELF LOCKING COUPLING NUT. AVAILABLE ONLY ON CODES 40, 41, & 54.

UNLESS OTHERWISE SPECIFIED DIMENSIONS ARE IN INCHES	MATERIAL AND FINISH PER NOTES DO NOT SCALE DRAWING	TOLERANCES: .XX = ± .06 .XXX = ± .03 ANGLES = ± 2°	CAGE CODE 31461	FILE NO. 0\SALES\30800	DR ATP 5/3/04	CHK G.F.	APP 02/26/09	REV. D
---	--	--	-----------------	------------------------	---------------	----------	--------------	--------